



Walla Walla Community College

The Buildings of Walla Walla Community College

Campus Loop Buildings

- A** – Dietrich Activity Center (Gym, 510)
- B** – Parent Child Center (514)
- D** – Main Building (520)
- E** – Health Science & Performing Arts (535)
- F** – Technology Center (537)
- J** – Prof-Technical Building (550)
- W** – Student Recreation Center (530)
- SEA-Tech** Skills Center (525)

Water Center Drive Buildings

- H** – Energy Systems Tech. (618)
- K** – Bright Beginnings Day Care (611)
- L** – Diesel Mechanics I (621)
- M** – Diesel Mechanics II (623)
- N** – Grounds Maintenance (625)
- P** – John Deere Training Center (629)
- R** – Water & Environmental Center (640)

E. Isaacs Buildings

- T** – Center for Enology & Viticulture (3020 E. Isaacs)
- U** – Automotive Technology Center (3060 E. Isaacs)

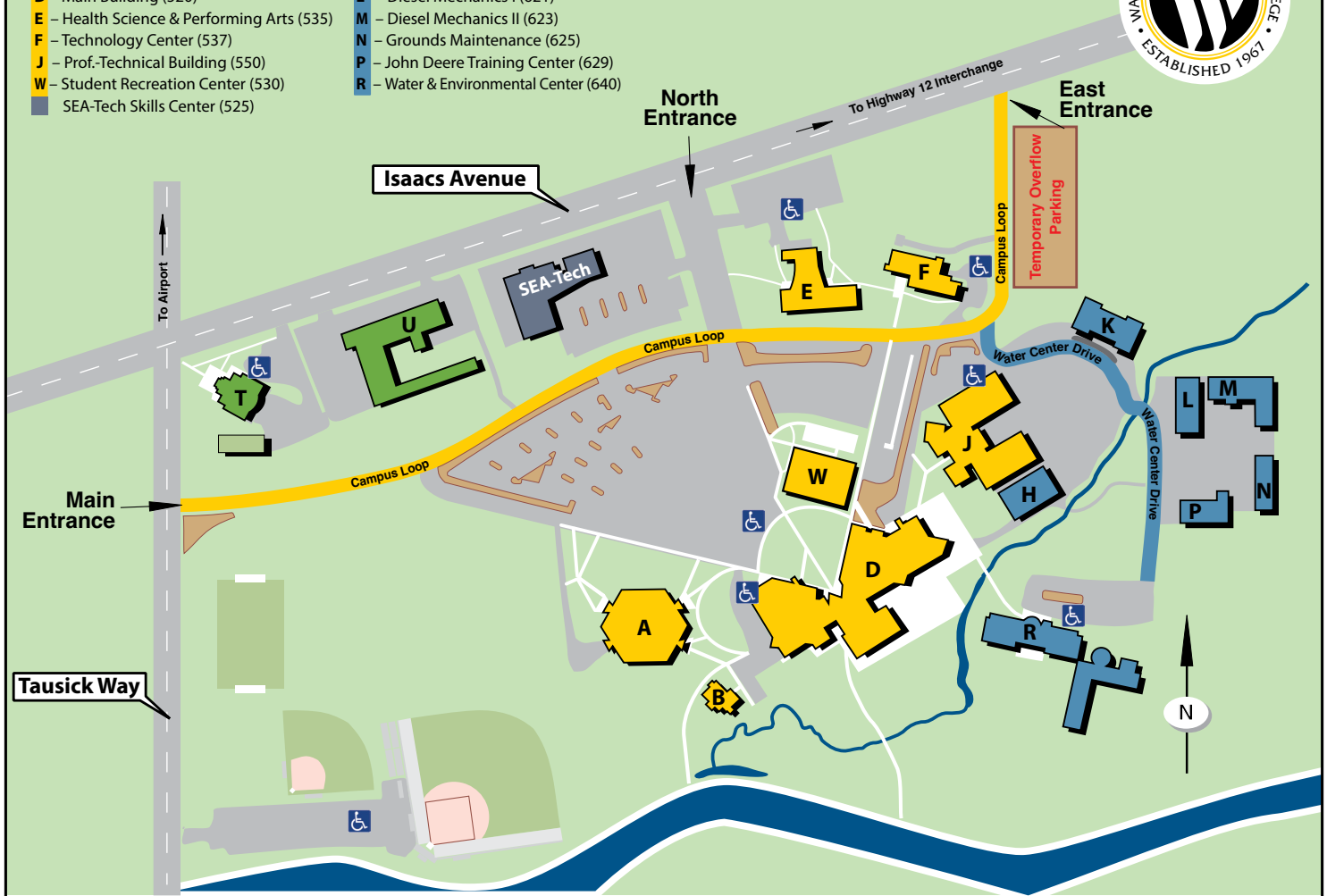

Walla Walla Community College...Shape Your Future!

500 Tausick Way, Walla Walla WA 99362

Information
509.522.2500

FAX
509.527.4480

Web Site
wwcc.edu

TDD
509.527.4412

Walla Walla Community College does not discriminate on the basis of race, color, creed, national origin, sex, sexual orientation, including gender expression/identity, genetic information, marital status, age, the presence of any sensory, mental, or physical disability; the use of a trained guide dog or service animal by a person with a disability; or, status as a Vietnam and/or disabled veteran, National Guard member or reservist.

Walla Walla Community Colleges posts an Annual Security Report online. A paper copy of the report may also be obtained, free of charge, by visiting the Campus Security and Environmental Health and Safety office during normal business hours. The report contains policies and procedures related to campus safety and security, three years of crime statistics and other additional safety information.

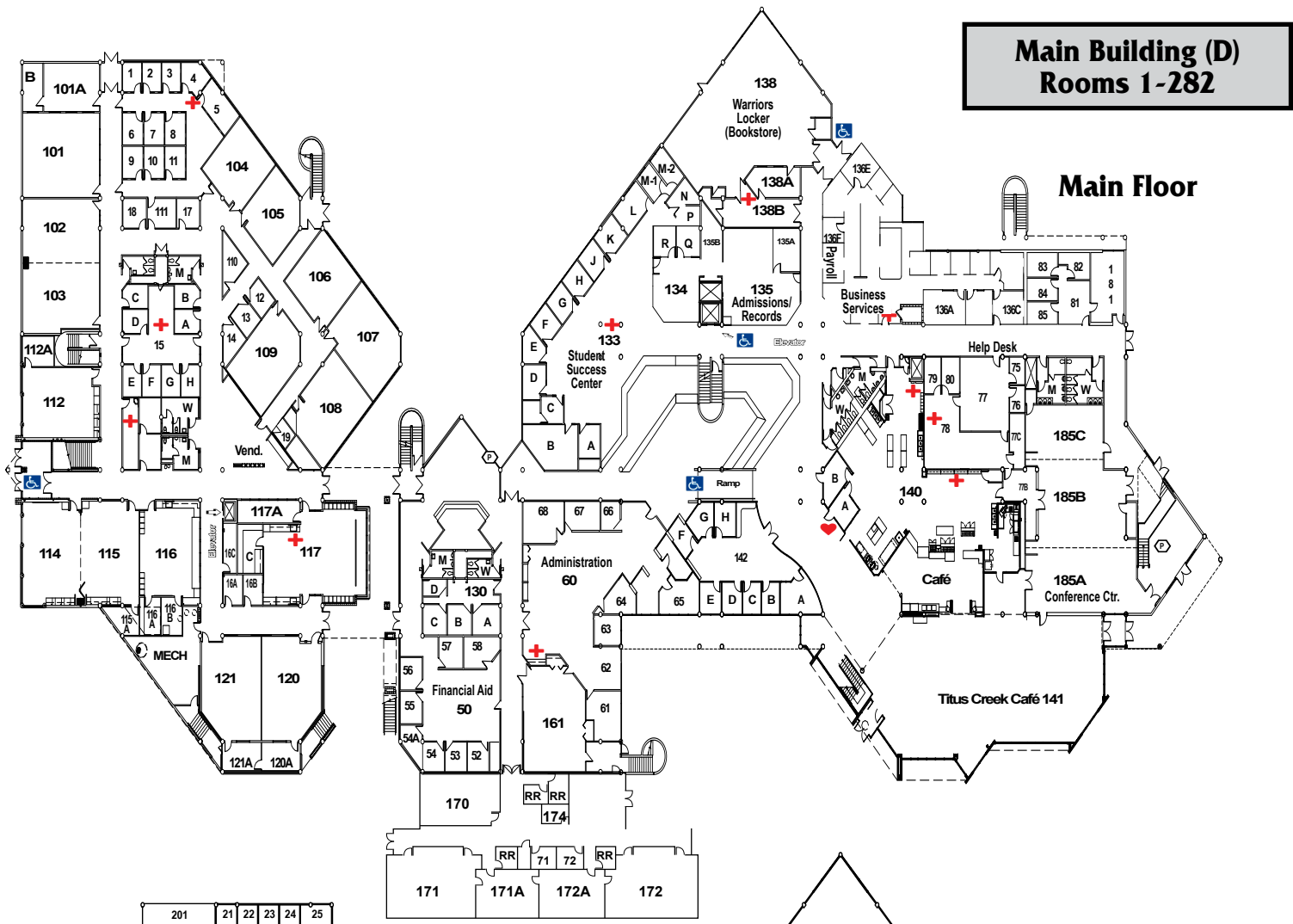

Energy Systems Technology (H)

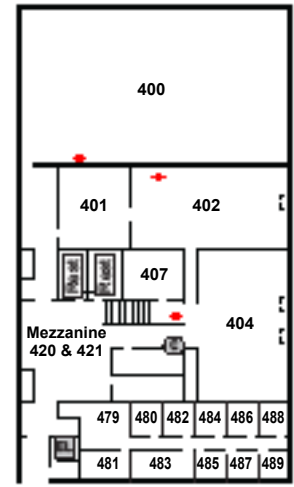

Professional-Technical Building (J) Rooms 300-346

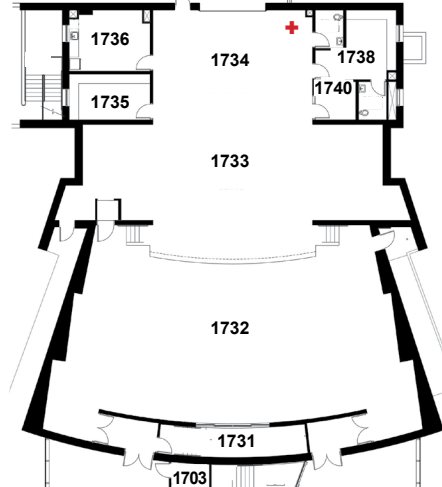
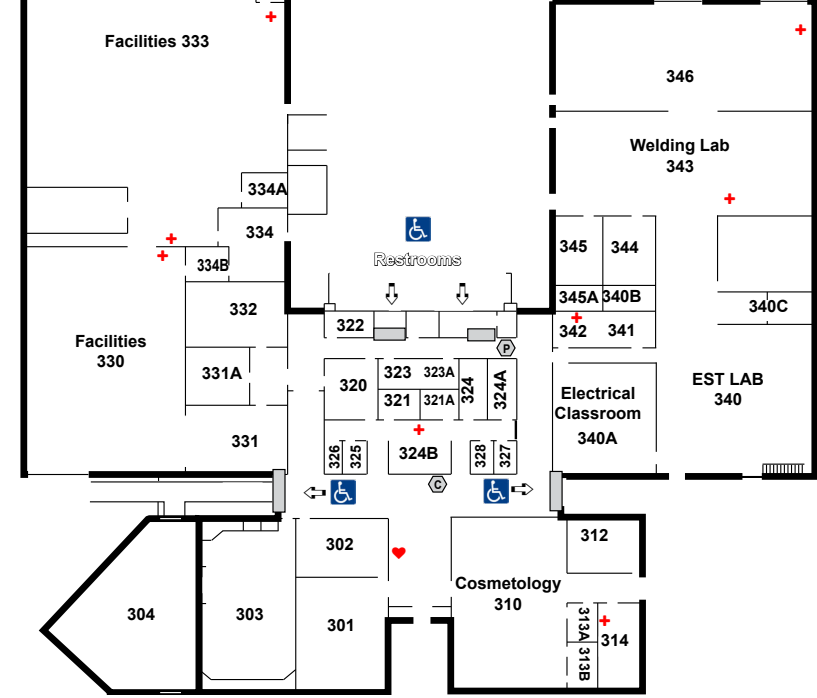

Health Science & Performing Arts Center (E) Rooms 1703-1836

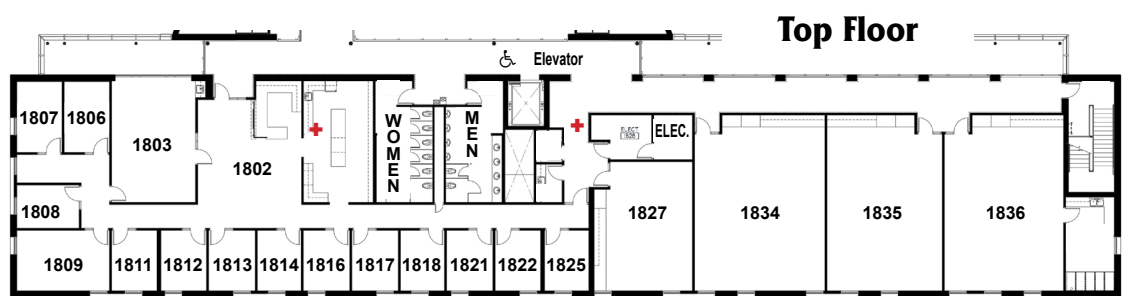
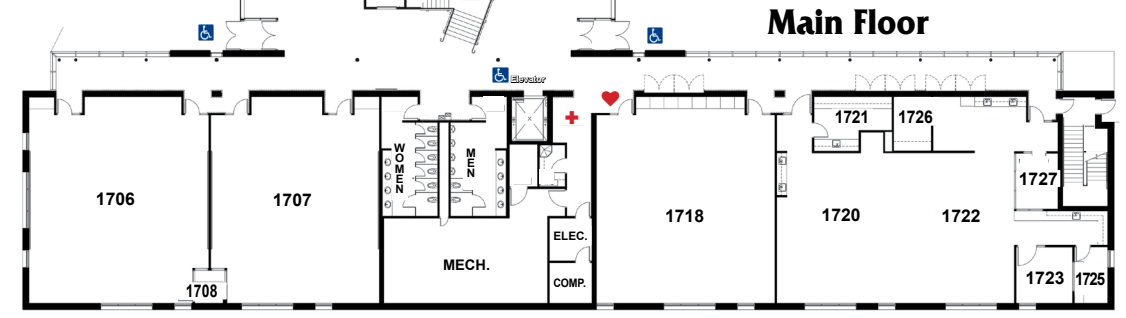
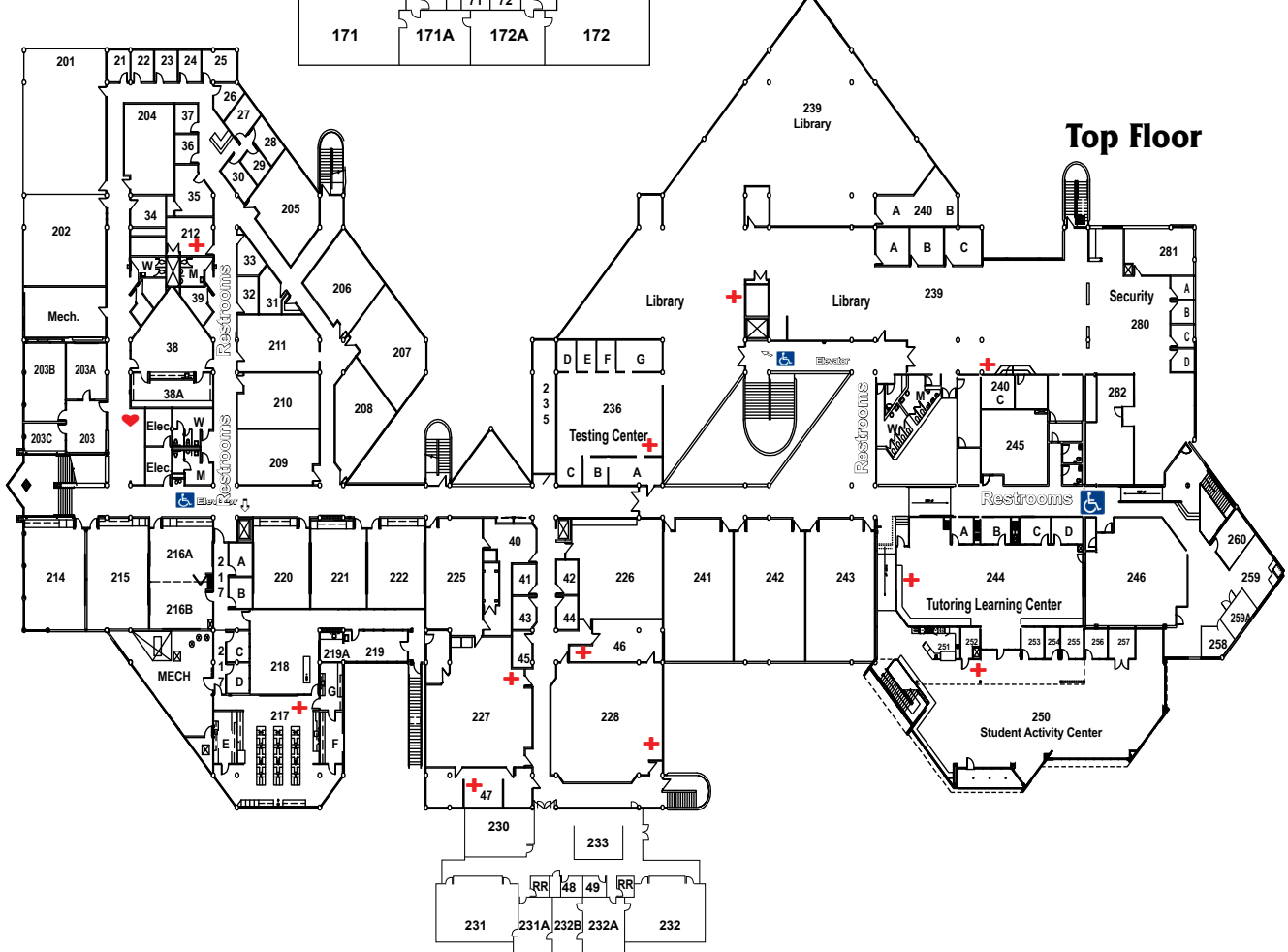

**Technology Center (F)
Rooms 1101-1215**

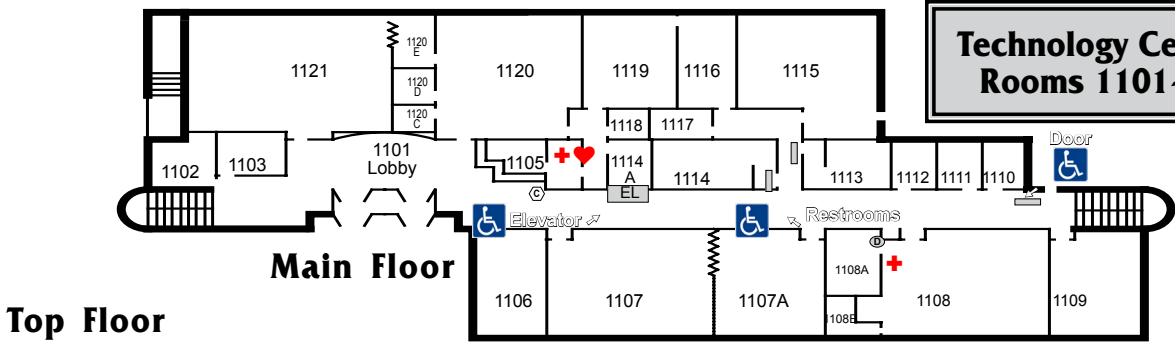

Top Floor

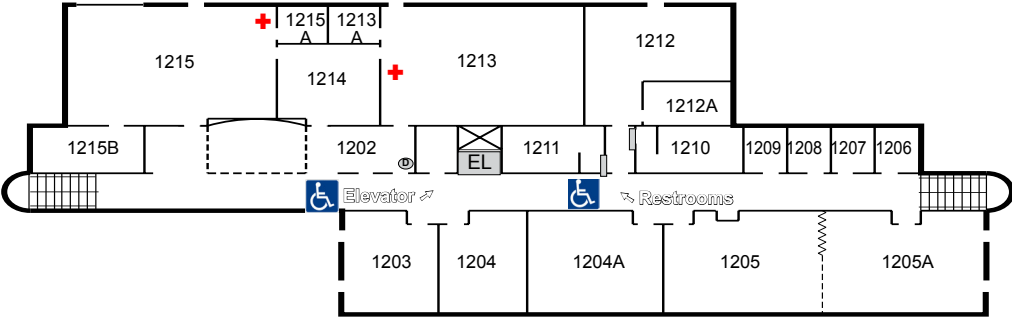

Dietrich Activity Center (A)

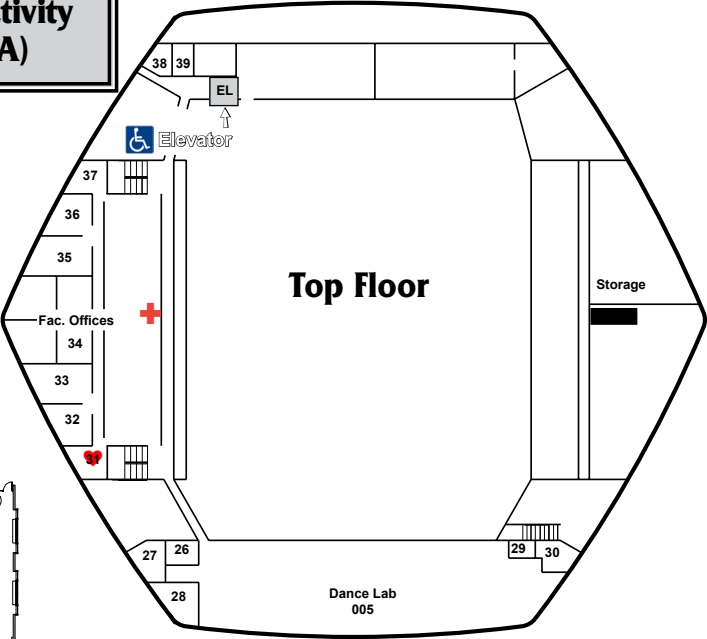
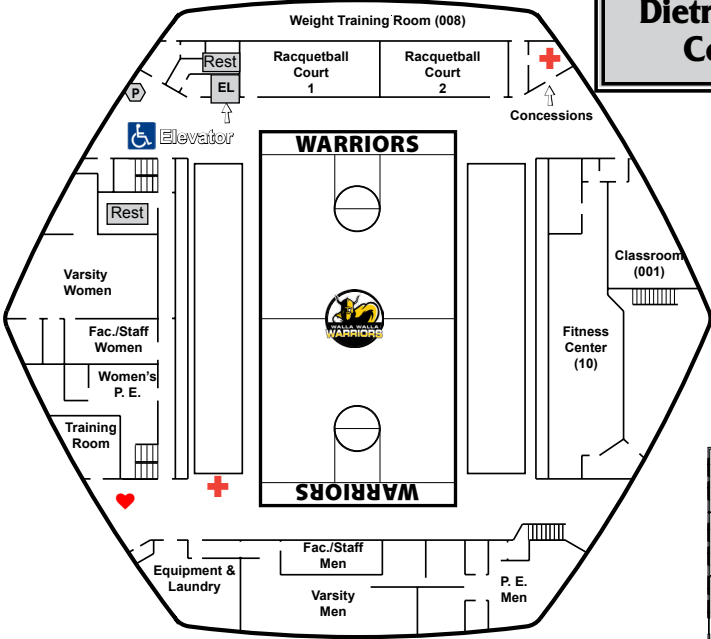

**Water & Environmental Center (R)
Rooms 2002-2096**

